

# Data sheet



## Hybrid Coaxial Surge Protectors **CXF**



- Multi-Point Radio & Backhaul Bridges
- Tower Mounted Amplifiers (TMA)
- Global Positioning Systems (GPS)
- Antenna Systems
- Tower Top Electronics (TTE)
- Transmitters and Receivers
- WiFi
- Wimax Broadband Wireless

## Dimensions and Diagram

CXF60

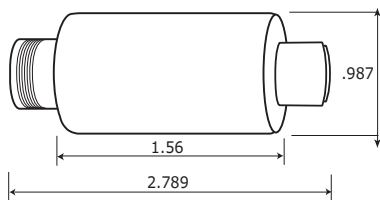

## Characteristics

CITEL Part Number	CXF60
Frequency Range	3-500MHz
DC Turn-On (Breakdown)	+60Vdc
Technology	Hybrid DC Pass
Insertion Loss	<0.3db
Return Loss	>20db
VSWR	<1.2:1
I <sub>peak</sub> (8/20 μs)	20kA
Max Power	42W
Max current	6A
Impedance	50 omhs
<b>Mechanical Characteristics</b>	
Connection Method	Series
Connectors	N
Grounding	M6 Screw, Bulkhead, Bracket
Environmental Rating	IP65
Operating Temp	-50°C to +85°C
Operating Altitude	13,000 ft (4,000m)
Relative Humidity	up to 5 to 95% non-condensing, up to 100%
Weight	8.6 oz



# CITEL